

### Features

0.32" digit height (Digital)  
High segment intensity  
Range of colours  
Multiplexing capability  
ROHS Compliant

### Options

Black or Grey face colour  
Colored segments  
Copper terminal pins  
Long terminal pins  
Low current version



### Electro Optical Characteristics $I_F = 20\text{mA}$ ( $T_A = 25^\circ\text{C}$ )

Part Number		Emitting Colour	Wavelength Peak $\lambda_P$ (nm)	Forward voltage $V_F$ (V)	
Common Cathode	Common Anode			Typical	Max
032R1B SB	032R1A SB	Superbright Blue	460	2.9	3.2
032R1B UB	032R1A UB	Ultrabright Blue	460	2.9	3.2
032R1B SG	032R1A SG	Superbright Pure Green	530	3.0	3.4
032R1B UG	032R1A UG	Ultrabright Pure Green	530	3.0	3.4
032R1B UYG	032R1A UYG	Superbright Yellow Green	560	2.0	2.2
032R1B UOR	032R1A UOR	Ultrabright Amber	610	1.9	2.2
032R1B UY	032R1A UY	Ultrabright Yellow	590	1.9	2.1
032R1B SR	032R1A SR	Superbright Red	650	1.9	2.1
032R1B UR	032R1A UR	Ultrabright Red	660	1.9	2.1

### Absolute Maximum Ratings $T_a=25^\circ\text{C}$

Characteristic	Symbol	Rating	Unit
DC forward current	$I_F$	20	mA
Reverse Voltage	$V_R$	5	V
Operating Temperature	$T_{opr}$	-25 to +80	$^\circ\text{C}$
Storage Temperature	$T_{stg}$	-30 to +85	$^\circ\text{C}$
Lead Soldering Temperature <sup>1</sup>	-	260	$^\circ\text{C}$

<sup>1</sup> 1.6mm from body – max 3 seconds

### Product Diagram (All dimensions are in mm)

0.32" digital

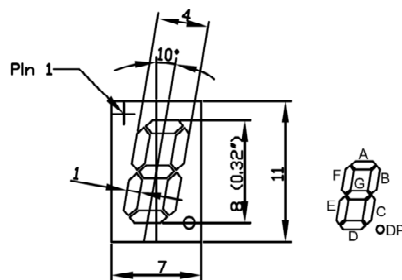

032R1B xxx  
Common  
cathode

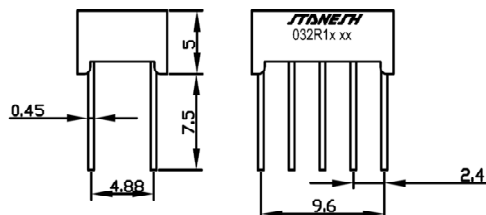
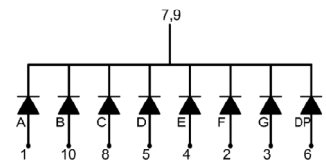

032R1A xxx  
Common  
anode

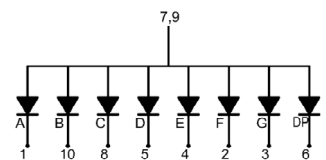

\*Specifications may change due to new materials or product improvement